

AD30NA4L (R100)

Product Feature:

- ◆ Onboard Intel Alder Lake-N serial processor
- ◆ 1*DDR5 SO-DIMM, Max 16GB
- ◆ 4*2.5G network ports, choose POE
- ◆ TPM2.0, 1*M.2 2280 SSD, MiniPCIe(WIFI/BT/4G/mSATA)
- ◆ HDMI2.0+DP, 1*Type-C (USB+DP)

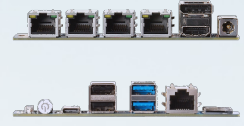
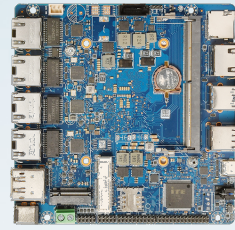

Product Feature

Processor	Onboard Intel Alder Lake-N serial processor, TDP 15W
	EFI BIOS
Ram	1*DDR5 SO-DIMM, Max 16GB
Storage	1*M.2 M-Key 2280(NVMe PCIe 4.0 x2/SATA3.0 protocol)
	1*SATA3.0 slot, 2Pin 5V power
Display port	1*HDMI2.0, support 4096x2160@60Hz
	1*DP, support 7680x4320@60Hz
	Type-C, support DP 7680x4320@60Hz and USB3.2 Gen2
I/O interface	Power on button, reset button, 2*USB3.0, 2*USB2.0, TF card
	DC JACK, HDMI+DP, Type-C
	4*2.5G LAN (3*Intel 226-V, 1*RTL8156B, optional POE), RJ45 console
Extended Interface/Function	External TPM2.0 is optional, not available by default. Default is CPU built-in TPM2.0.
	1*Mini PCIe (PCIe+USB2.0+SATA3.0 protocol, WIFI/BT/mSATA/4G module), Micro SIM card
	5*RS232/RS485 pin (hardware material selection), pitch 2.0mm; 4*GPIO
	1*4Pin PWM CPU FAN; 1*4Pin PWM SYS FAN
Power	DC 12-19V, 36W or above
working environment	Operating Temperature: -20°C ~ +60°C; Operating Humidity: 5% ~ 90%
	Storage Temperature: -40°C ~ +85°C; Storage Humidity: 5% ~ 90%
operating system	Windows 10, Windows 11, Linux
Size	120x120 mm
Net weight	Approx. 120g without heat sink, approx. 220g with heat sink

AD30NA4L (R100)

Product Size

Unit: mm

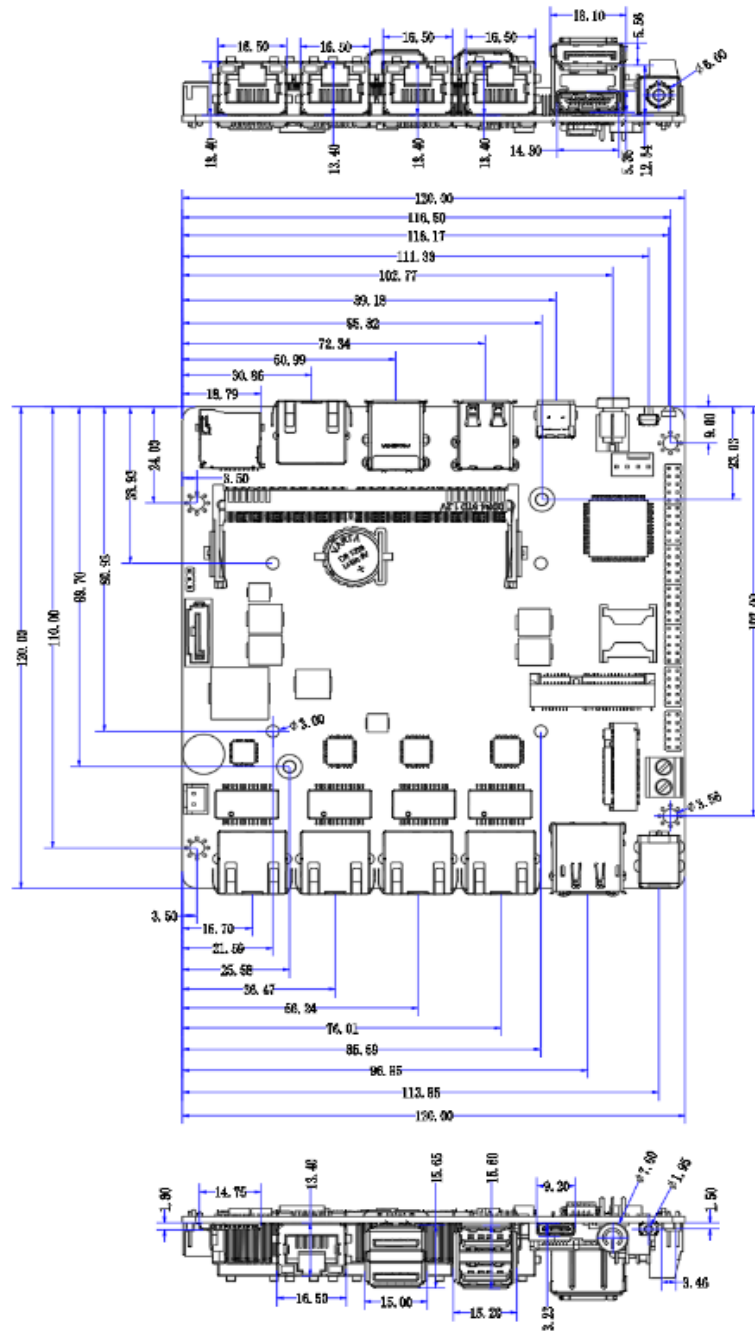

Ordering Information

Model	Optional	Optional Description
AD30NA4L	Onboard Intel Alder Lake-N Series Processor	N95/N100/N305
	POE	POE optional
	RS232/RS485 optional	RS232/RS485 selectable by hardware material
	TPM2.0	External TPM2.0 optional